

200TM 
Years of Train Travel
Since 1825



FAMILY DAY

IN CELEBRATION OF RAILWAY 200

**YEAR 1
NIGHTINGALES**



KATES HILL
PRIMARY
Dudley

PROFITS WILL GO TO:



FOREWORD

Neil Fulton,
Chief Executive, BCIMO



We're thrilled to welcome the community for a day filled with celebration, information, and shared experiences. This event brings together families, partners, and rail enthusiasts from across the region to explore the past, present, and future of rail — all while raising vital funds for five incredible charities.

There's something for everyone to enjoy, with a packed programme of activities and experiences — including exclusive rides on the Coventry Very Light Rail (CVLR) vehicle, the chance to step aboard our historic T69 tram, and the chance to try out our state-of-the-art driver simulator. Families can look forward to a wide range of attractions, from fairground rides, model railways, and creative crafts to face painting, family-friendly live shows, and delicious food.

We're proud to be raising funds for five amazing charities: The Kaleidoscope Plus Group, Railway Benefit Fund, 4Louis, Railway Children, and Young Lives vs Cancer. Every ticket, raffle entry, and donation helps support their vital work.

Today also marks our involvement in Railway 200, a national celebration of 200 years of rail. As we reflect on that remarkable legacy, we also look ahead — and BCIMO is proud to be helping shape the next generation of rail innovation and sustainable transport.

A special thank you goes to Coventry City Council, our main event partner, for providing the Coventry Very Light Rail rides that form such a memorable part of today's experience.

We're also incredibly grateful to all our sponsors, whose financial support and in-kind contributions have helped make today possible. Their range of stalls, shows, presentations, and activities has helped create a vibrant and engaging experience for everyone, playing a key role in the success of today's event.

A heartfelt thank you to our incredible volunteers helping today, and to the BCIMO team, whose time, energy, creativity, and commitment have been instrumental in bringing this ambitious event to life. Today simply wouldn't have been possible without you.

A special thank you also goes to Pete Waterman OBE — music legend, proud ambassador for Railway 200, and President of the Railway Benefit Fund — for officially opening today's event.

And thank you to the Mayor of Dudley, who will be introducing our charity raffle, which brings the day's programme to a close.

We hope you have a fantastic time.

Coventry VeryLightRail



**You are invited to join us
on a test ride on Coventry's
innovative new Very Light
Rail vehicle**

**Book now at:
[coventry.gov.uk/
VLRRoadTest](https://coventry.gov.uk/VLRRoadTest)**



FAMILY DAY MAP LEVEL 2

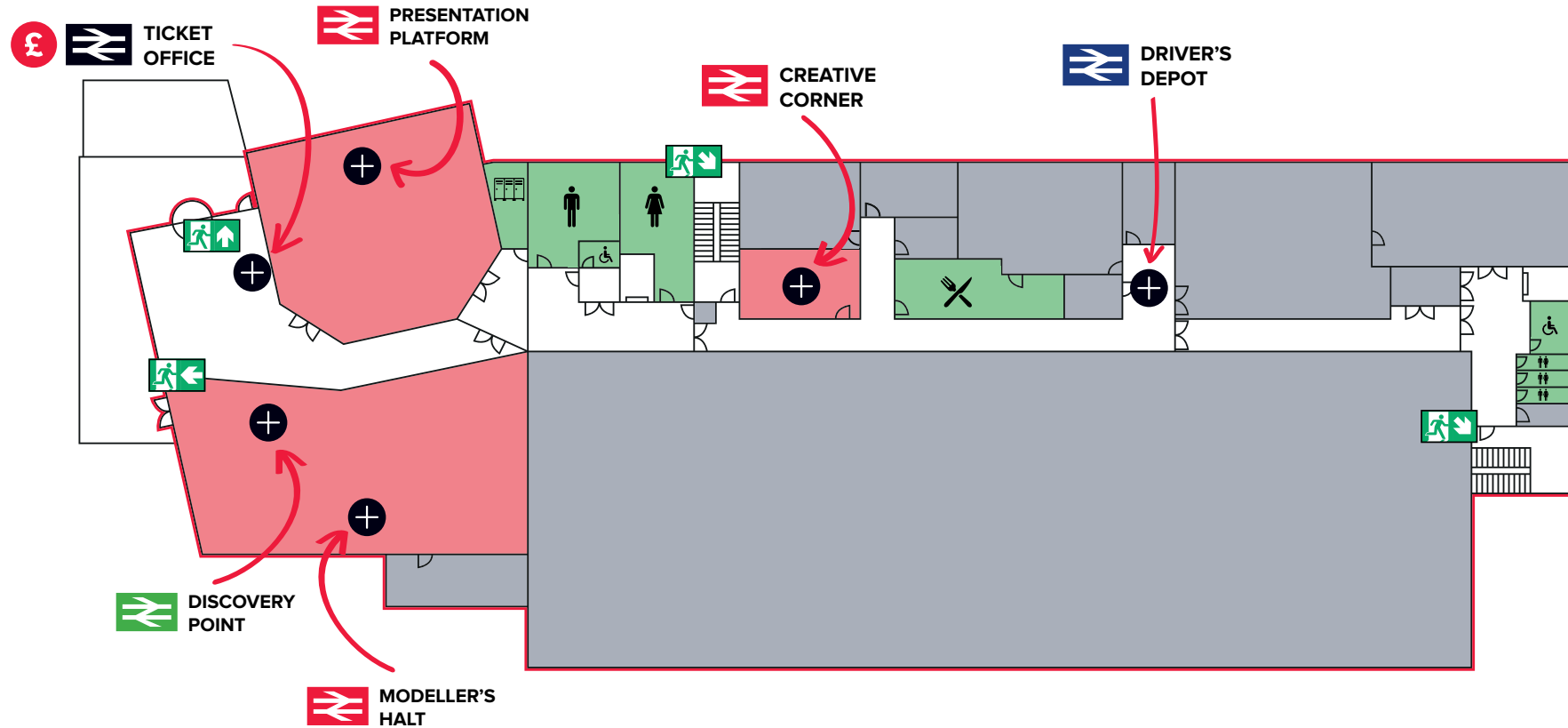

- | | | |
|-----------------|----------------|----------------------|
| Fire Exit | Women's Toilet | Unisex Toilet |
| Disabled Toilet | Men's Toilet | Kitchen - Staff Only |
| | | Locker Room |

- | | | | | | |
|-------------------|----------|---------------|-------|------|--------|
| £ ADDITIONAL COST | ENTRANCE | ENTERTAINMENT | RIDES | FOOD | STALLS |
|-------------------|----------|---------------|-------|------|--------|

FAMILY DAY MAP OUTSIDE

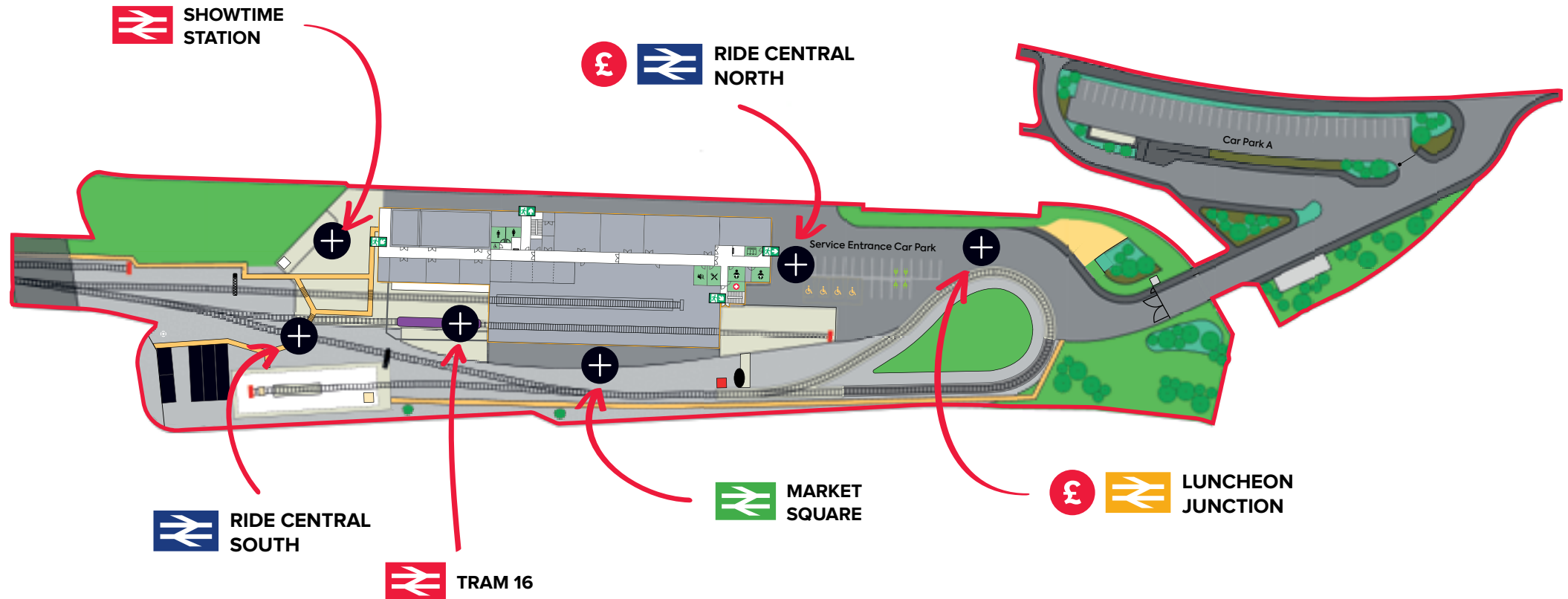

Fire Exit



Disabled Toilet



Women's Toilet



Men's Toilet



Baby Changing



Kitchen - Staff Only



First Aid



Quiet Room



Locker Room



ADDITIONAL
COST



ENTRANCE



ENTERTAINMENT



RIDES



FOOD



STALLS

let's give your **brand** some

ooooooooomph

Creative design and brand marketing communications, built around strategy to **boost your business growth.**
eleven10creative.agency

eleven10
creative agency



We're expanding!

Bringing fast, reliable, and sustainable travel to even more communities.

We're on track to connect Dudley to our growing network, making it easier than ever to get to work, access leisure activities, and explore the region.

Stay up to date
westmidlandsmetro.com

West Midlands Metro
your journey, our passion



RailBusinessDaily

A force for good in rail, and for your business

RailBusinessDaily

- ✓ Newsletter to 73,000+ rail professionals, 6 days a week
- ✓ Social media promotion to 28,000+ LinkedIn followers
- ✓ 250+ stories published monthly
- ✓ Home of 'In the News'

The latest rail news 7am every day

RailDirector

- ✓ High end industry-leading magazine
- ✓ Delivered direct to key influencers and decision-makers
- ✓ Latest news and views
- ✓ Readership of up to 15,000

LORD HENRY

Special focus every month

To discuss how we can help to tell your story, or to advertise, contact us today. ☎ Chrisw@railbusinessdaily.com ✉ 07494 529803



Designer Class Industrial Printers

CONSTRUCT3D

Introducing the UK's fastest premium 3D printer – our cutting-edge technology is designed to deliver industrial grade quality, packaged in a beautiful form-factor. This love letter to 3D printing enables designers and engineers to focus on what they do best.

Independently tested and validated class leading performance means you can print larger and more complex models in less time than ever before with full confidence, allowing you to take your projects to the next level.

The Construct 1 is the UK's fastest 3D printer, boasting exceptional quality, speed, and reliability. With a print speed that is 5x faster than the competition, the Construct 1 is the perfect choice for those who are looking for a high performance printer that can handle a wide range of printing projects.

If you want to print larger more complex parts, the Construct 1 XL is perfect for you. Featuring the same advanced motion control system, and a high-performance extruder, the Construct 1 XL is great for larger parts or batch printing. The Construct 1 XL is a hot favourite for heavier industry, currently beloved and deployed in both the Defence and Rail sectors.

Starting At £3695

WWW.CONSTRUCT-3D.COM
@Construct3D-AM



Ticket Office

Start your Family Day adventure here:

- Buy tickets on the day
- Check in with our friendly team
- Pick up event information to help you navigate everything on offer



Merchandise

Visit the BCIMO Merchandise Stall and take home a unique keepsake from the day:

- 3D-printed railway accessories
- Doorstops and bookends made from real railway track
- Plus, grab your raffle tickets and be in with a chance of winning some amazing prizes



Mascots

Get ready to meet some very special guests:

- Thomas the Tank Engine
- The Fat Controller
- Kally the Stigmasaurus
- Gracie the Lion
- Phipps the Fox
- Toby the Dog

Don't forget to take a photo to capture the moment!



Supporting Mental Health and Wellbeing in Our Community

Life isn't always easy — and that's okay. At Kaleidoscope Plus Group, we're here to help you and your loved ones take care of your mental health and wellbeing.

Discounted Counselling Service to Support:

- | | |
|------------------------|---------------------------|
| • Anxiety | • Sexuality spectrum |
| • Stress | • Gender identity |
| • Depression | • Trauma |
| • Self harm | • Work-related stress |
| • Suicidal thoughts | • Relationship breakdowns |
| • Loss and bereavement | |
| • Low self-esteem | |

Learn more



0121 565 5605



kpg.org.uk

Registered Charity: 1096473



Presentation Agenda

TIME	SESSION	ITEM	WHO
10:00	Event Opens		
10:30	Welcome	Event Welcome Opening Address	Neil Fulton, CEO, BCIMO Pete Waterman OBE, President, RBF
11:30	The History of Rail	The History of Rail Rail in the Black Country Dudley Underground	Lawrie Rose, Lawrie's Mechanical Marvels Ned Williams Anthony Poulton-Smith
12:30	Children's Hour	Welcome by the Mascots Curtain Call Chaos Balloon Modelling Photo Opportunity with the Mascots	<ul style="list-style-type: none"> Thomas the Tank Engine The Fat Controller Kally the Stigmasaurus Gracie the Lion Toby the Dog Tristan Jones-Smith, Wolverhampton Grand Theatre Gemma Biddulph, Splat Attack
13:30	The Future of Rail	Coventry Very Light Rail West Midlands Metro Cirencester Community Railway Clean Futures Innovations 3D Printing in Rail Robot Dog Applications in Rail Stourbridge Lion 2029 Project	Angus Brummitt-Brown, Senior Project Manager (Very Light Rail), Coventry City Council Sophie Alison, MD, West Midlands Metro Richard Gunner, Chair, Cirencester Community Railway <ul style="list-style-type: none"> Anjali Devadasan, CEO, Treeva Naim Kapadia, Head of Engineering, Grinsty Rail Therese Lord, Director, Construct 3D James Brown, Managing Director, NextGen Ri Ian Flynn, Stourbridge Lion 2029 CIC



Presentation Agenda

TIME	SESSION	ITEM	WHO
14:30	Charity Presentations	The Kaleidoscope Plus Group Railway Benefit Fund 4Louis Railway Children Young Lives Vs Cancer	Callum Nisbet, CEO Pete Waterman OBE, President and Jo Kaye, CEO Victoria Usher, Events and Donations Officer Alex Sperr, Community Engagement Worker Rachel Kelly, Fundraising Engagement Manager
15:30	Raffle Prize Draw	Introduction to Raffle Prize Draw Raffle Prize Draw Closing Remarks	Mayor of Dudley Compere Neil Fulton, CEO, BCIMO
16:00	Event Closes		





Neutrino
100 YEARS
Excellence in Event Production
Creative use of technology by a global team of partners

Sustainable	Inventive	Collaborative
We source locally to minimise our carbon footprint, ensuring our operations are environmentally responsible	We leverage emerging technologies to captivate audiences, continually innovating our processes	We collaborate with a global network of specialists and partners, enhancing our service reach and quality

Visit our website at: www.neutrino.co.uk



X² WORKSPACES
EXCEPTIONAL INTERIORS

www.x2workspaces.co.uk

COMMERCIAL FURNITURE | INTERIOR REFURBISHMENT
2D & 3D SPACE PLANNING & DESIGN | ERGONOMIC ADVICE & SOLUTIONS
ACOUSTIC ADVICE & SOLUTIONS | REUPHOLSTERY SERVICE
& MUCH MORE!

Contact Clive On: 07808 131955 Or Rob On: 07964 847454
e: hello@x2workspaces.co.uk

WHAT'S ON
LEVEL 2



DISCOVERY
POINT

Discovery Point

Discover a mix of visitor attractions, including local favourites from Dudley Council's *Discover Dudley*, alongside businesses and organisations from further afield.

Explore offerings from educational providers in the region, Black Country heritage with the Stourbridge Lion and Black Country Society, plus exciting innovations like 3D printing.





SUPPORTING THE UK RAIL INDUSTRY

President of Railway Benefit Fund, Pete Waterman OBE

My love of rail began in 1947, where I was born to the sounds of engines chugging past my cot. The UK railway industry has always been close to my heart, because let's face it railway people are fabulous.

Which is why I am proud of my role as President of RBF, to help raise the profile of the great work we do. The history of the charity is just incredible, some of its patrons in the past have included Charles Dickens. It's rewarding to be a part of a charity which supports railway people facing hardship in the UK.

Who we are

Railway Benefit Fund is a non-membership charity that provides financial support to the railway community and their dependents across the UK.

We have been supporting railway people for over 165 years. Every four minutes somebody reaches out to RBF for help and advice.

How we support you

We offer a range of support services, for the UK rail industry, including confidential advice, online resources, a dedicated legal helpline and financial grants. These support services are designed to help individuals and families navigate life's unexpected challenges.

What you can do to support our railway family?



We rely solely on the generous support of our railway industry to raise vital funds for railway people facing hardships. Thank you.



Railway Benefit Fund, 1st Floor Millennium House, 40 Nantwich Road, Crewe, CW2 6AD
info@railwaybenefitfund.org.uk / 0345 241 2885 / www.railwaybenefitfund.org.uk
Registered Charity No: 206312/SC039550

WHAT'S ON
LEVEL 2



MODELLER'S
HALL

Cradley Heath Model Railway Club



Blackbrook Halt

Set in the 1960s, this fictional Black Country yard served a ship anchor foundry, with Pannier tanks from Stourbridge and a rarely used halt linking two lines.



Halfpenny Green

Opened in 1925, the Wombourne branch line was intended to reach Bridgnorth but halted at Halfpenny Green.



The Basin

Set in 1920s eastern England, the layout is a snapshot of a post war industrial area, where the railway served the canal and local industries.

West Midlands Narrow Gauge Group



Cwm Hir

Inspired by Welsh narrow-gauge railways, Cwm Hir portrays a rural Powys line from a century ago.

West Midlands N Gauge Club



Gibben Quarry

Gibben Quarry is a fictitious rural station with an off-scene stone quarry, there are sidings for wagons in and out and a tower for loading stone into wagons.

Will Jarman & Son

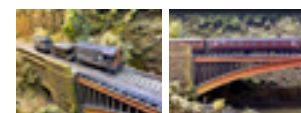

Victoria Bridge

Victoria Bridge is an N Gauge working diorama of the iconic Severn Valley Railway bridge. Trains range from heritage favourites to modern stock, including luxury dining cars and the Class 139 from Stourbridge.

Birmingham Model Railway Club



Sainte Marie

Built in just a month, this layout began on 27 August 2023 with only an empty baseboard and a vision. Set in 1960s Sainte Marie, a fictional village in southeast France, it can also represent the 1980s with minor changes to vehicles, figures, and details like Le Tour de France.



St Michael's Town

A typical small town in western USA depicting an American narrow-gauge line. The layout was designed by Paul Walton and was built with help from other BMRC members including Andrew Weaver and Therese Weaver.



What's On TV?

A micro layout built inside a vintage TV set with several small modules built by members of the Birmingham model railway club to allow us to (change channel).



Tehachet Butte F&Cry

A HOe American narrow gauge micro layout built on a cake board, built by 009 society and Birmingham model railway club member Paul Walton.



00 Gauge Bicycle Wheel

A unique layout with a loop of 00-gauge track inside a bicycle wheel that allows the weight of the locomotive to turn the wheel.



Yn Nodi Pren

A typical Welsh narrow-gauge railway depicting a small station in a forest with many hidden animals to find. The layout is named in memory of Andrew's late father Mark Weaver, Yn Nodi Pren is the Welsh translation of Marks Wood.

POWERED by CAN

CHARGING UP CHILDREN AND YOUNG PEOPLE WITH PEOPLE POWERED CHANGE

Scan to find out more

JOIN OUR JOURNEY

in d f i x v pbcanofficial

www.poweredbycan.org



PARTY MASCOT HIRE

Over 100 Costumes To Choose From
Nationwide Delivery To UK Mainland
With As Little As 24 Hour's Notice!

ORDER ONE OF OUR MASCOTS FOR YOUR NEXT PARTY OR EVENT WITH EASE

HOW TO ORDER

Browse through our wide selection of mascots and order your favourite.
Each mascot is only just £20 (excl. VAT) including return postage.
We also have 24-hour delivery for all orders. We'll deliver when the mascot is returned to us.
You will receive the mascot the day prior to your agreed hire date by Parcel Post.
We will ensure full and exact matching when the mascot is on the way to you.
There are opening, entry and exit of these mascots right up to when your mascot is returned to us.
Place the mascot safely back in the box and attach the return label we provide you with.
Wrap the package in your nearest post office. There is nothing to pay and you will receive a receipt of postage.
Once we have received the mascot back, your mascot hire will be refunded to your original payment method.

ORDER NOW!

www.partymascot.co.uk

BIOPICPHOTO LTD

Experienced, creative and reliable photography for:

- Schools & Graduation Events
- Professional Headshots
- Real Estate Listings
- Weddings & Celebrations
- Private & Corporate Events

UK Wide but Midlands Based

For more information:
www.biopicphoto.co.uk | 01842 616161

Creative Corner

Unleash your creativity with arts and crafts activities, perfect for all ages. From designing colourful creations to hands-on projects, you'll have the chance to make something unique to take home.

Whether you're crafting a masterpiece or simply having fun, there's something for everyone to enjoy!



Proud to Support



Supporting our  to help families of child loss

4Louis is a charity that works across the UK to support anyone affected by miscarriage, stillbirth and the death of a baby or child. We also work to improve the care bereaved families receive from healthcare and other professionals.



Families who have experienced such trauma are at the core of everything we do. Thanks to all of the hard work of our supporters we now supply memory boxes, CuddleCots & CuddleBlankets as well as bereavement suites to hospitals across the UK.

Take on a challenge?

Whether you're into virtual races, organised runs, skydiving, charity walks, or bike rides, there's an event just for you! By participating, you'll be helping to raise vital funds for bereaved families while achieving something amazing.



Join our volunteers

As a volunteer, you will play a vital role in the production of our memory boxes. From creating heartfelt cards to carefully packing and preparing our memory boxes for distribution.



DONATE 



 @_4Louis

 4louis.charity

 4louis.charity

 /4Louis

www.4Louis.co.uk

Charity Reg No. 1172212



Driver's Depot

Ever wanted to drive a tram? Try out our photo-realistic tram driver simulator and take control of a tram, either along BCIMO's test track or through the streets of Coventry.

With immersive, high-quality imagery, you'll feel like you're truly behind the wheel. Whether you're a rail enthusiast or just after some fun, this is your chance to see if you have what it takes to be a tram driver!



**BLACK
COUNTRY
RADIO**

Proud to support

**BCIMO™
FAMILY DAY**

92.2 FM • 102.5 FM • DAB • ONLINE

blackcountryradio.co.uk

THE SOUND OF THE
BLACK COUNTRY

Keep up-to-date with news
from the Black Country!

[f](#) [i](#) [x](#) @weareBCR

**GIVE YOUR BUSINESS
A BOOST!**

and advertise locally using
Village Voice

— MAGAZINES —

Call today
01384 866688
07817 904477
villagevoice@hotmail.co.uk

BRAND NEW WEBSITE
www.villagevoice-online.co.uk



**SILVER
SPONSORS**

WE BELIEVE IN A WORLD WHERE EVERY CHILD CAN THRIVE AWAY FROM A LIFE ON THE STREETS.

Railway Children protects vulnerable children at risk of being lost to the streets across the UK, India and Tanzania.

Working with transport networks and communities, we intervene early to reach children, support families and influence policy – creating real, lasting change and ensuring children are safe, heard and empowered to reach their full potential.



**TOGETHER WE CAN GIVE
CHILDREN SAFETY, PROTECTION,
AND THE POWER TO CHANGE
THEIR LIVES.**



**FIND OUT HOW HERE:
WWW.RAILWAYCHILDREN.ORG.UK**

**RAILWAY
children**
No child lost to the streets



Registered charity number 1058991

**WHAT'S ON
OUTSIDE**



**LUNCHEON
JUNCTION**

Luncheon Junction

Take a break and refuel with a tempting selection of food and drink! From tasty street food and wood-fired pizzas to sweet treats like churros and waffles, there's something for every craving.

Quench your thirst with a refreshing choice of hot and cold drinks including non-alcoholic cocktails, wines and beers. Whether you're grabbing a quick bite or settling in for a relaxed lunch, this is the perfect spot to recharge before your next adventure.

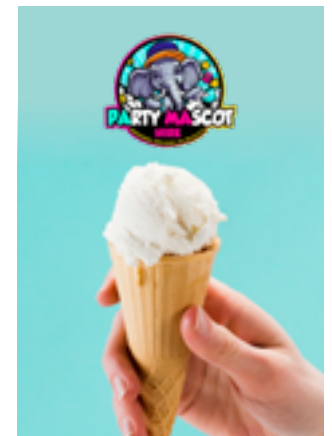
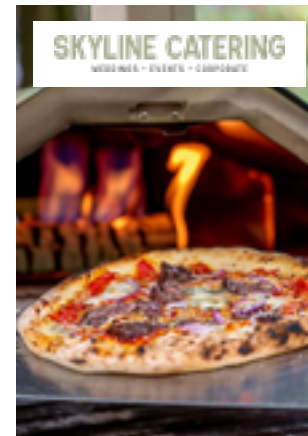



OPEN DAY



**Wednesday
11th June**

4pm - 7pm



Register now at
dudleycol.ac.uk



WHAT'S ON
OUTSIDE



RIDE CENTRAL
(NORTH)

Ride Central North

Head outside for classic family fun, where children can enjoy fairground rides, bounce on trampolines, test their aim with football goals, and try their luck at the hook-a-duck stall.

Plus, as an extra treat, they'll have the chance to climb aboard a real fire engine! This lively area is packed with playful attractions and plenty of opportunities for young visitors to burn off some energy.



Stourbridge Lion 2029

Looking back
to empower
the future



Visit our stand today

Engaging local communities in STEAM and engineering skills. We are looking for local companies to get involved and support our work to bring the Primary Engineer Programme into our local schools. Find out more at:

www.stourbridgelion2029.com

SILVER SPONSORS

YOUNG LIVES vs CANCER

THE CHARITY THAT ENSURES NO
FAMILY FACES CANCER ALONE

We help children, young people and their families
navigate the emotional and practical impact of cancer.

We do this through financial
grants, specialist social
workers and stays in our 10
Home from Home's across
the UK.

WE CAN'T DO ALL WE DO, WITHOUT
SUPPORTERS LIKE YOU.

For more information, please visit: younglivesvscancer.org.uk



WHAT'S ON
OUTSIDE



Market Square

Browse a great mix of family-friendly stalls offering toys, balloons, bubbles, sweets, fudge, books and more — perfect for little shoppers and those with a sweet tooth!

You'll also find a face painting station here, offering the chance to transform into a favourite character or simply add a splash of colour and fun to your day.

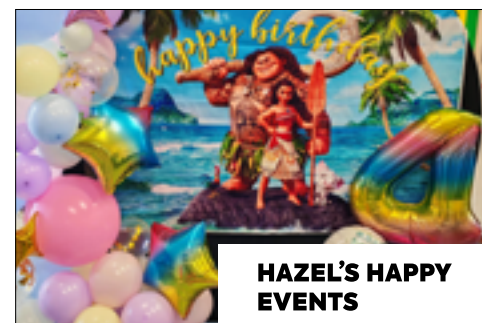

BRONZE SPONSORS



NED WILLIAMS



NextGen Ri



WILL JARMAN



WHAT'S ON
OUTSIDE



TRAM 16

TRAM 16

Step aboard the last T69 tram to be driven before the fleet's retirement in 2015 and discover how this iconic vehicle is now helping to shape the future of rail. Donated to BCIMO by UK Tram, it's currently being refurbished and used as a test vehicle for innovative rail technologies.

You'll even meet some of its original drivers, ready to share stories from its past and explain its new role in the world of rail innovation!



BEFORE



AFTER

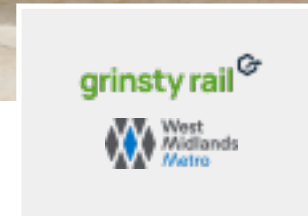

Ride Central South

Experience the star attraction of the day with a once-in-a-lifetime opportunity to ride on the Coventry Very Light Rail (CVLR) vehicle at the BCIMO facility. The exclusive journey takes you along the full test route, through the tunnel, and around the purpose-built 15m radius loop.

Be among the first to experience this groundbreaking technology before it heads to Coventry for public demonstration. Don't miss out on this exciting adventure!



RAIL DEVELOPMENT & TEST SITE



MEETING & EVENT SPACES

BCIMO provides a comprehensive suite of facilities for the development and testing of future rail technologies, complemented by six high-tech, flexible spaces that can accommodate between 8 and 170 guests.



BCIMO.CO.UK   

Performance Schedule

TIME	ITEM	PERFORMER
10:00	Event Opens	
10:30	Tae Kwon Do Demonstration	West Midlands TAGB Taekwondo
11:00	Meet the Mascots	<ul style="list-style-type: none"> • Thomas the Tank Engine • Fat Controller • Phipps the Fox • Gracie the Lion • Toby the Dog • Kally the Stigmasaurus
11:30	Acrobatic & Lollipop Routines	The Jewels Academy
12:00	Dance Performance	Amour Dance Studio
12:30	The Lost Baggage Porters'	Curious Cargo
13:00	Robot Dogs	NextGenRi
13:30	Dance Performance	Next Level Dance Academy
14:00	Marching Drill Demonstration	Dudley Sea Cadets
14:30	Live Music Performance	Buskerteers
15:00	Big Brass Sounds	Black Country Brass
16:00	Event Closes	



**RUNNERS
UP IN THE
DRAWING
COMPETITION**

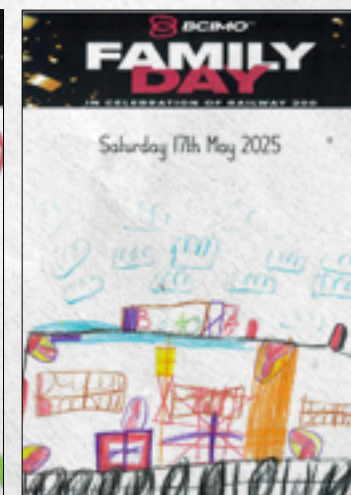
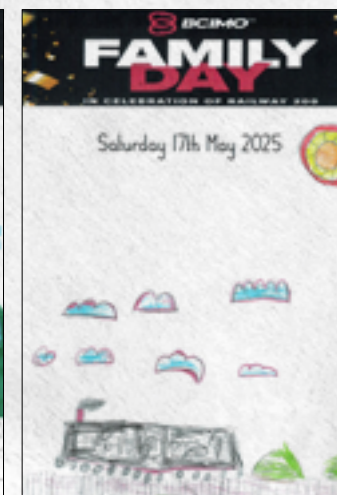



BCIMO.CO.UK

